

What's New with

Cisco Webex Teams



desktop
mobile

Send Animated GIFs

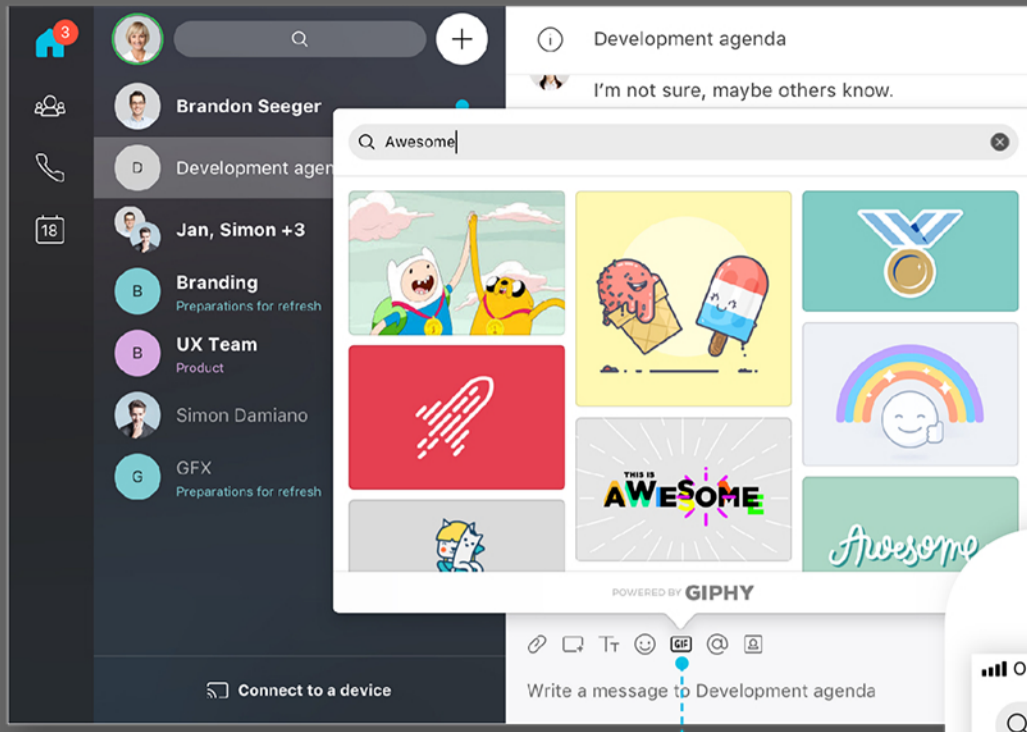

You can share animated GIFs in Webex Teams by accessing GIPHY directly from the app so you can find just the right one to personalize your message.

Click **GIF** to add an animated GIF.

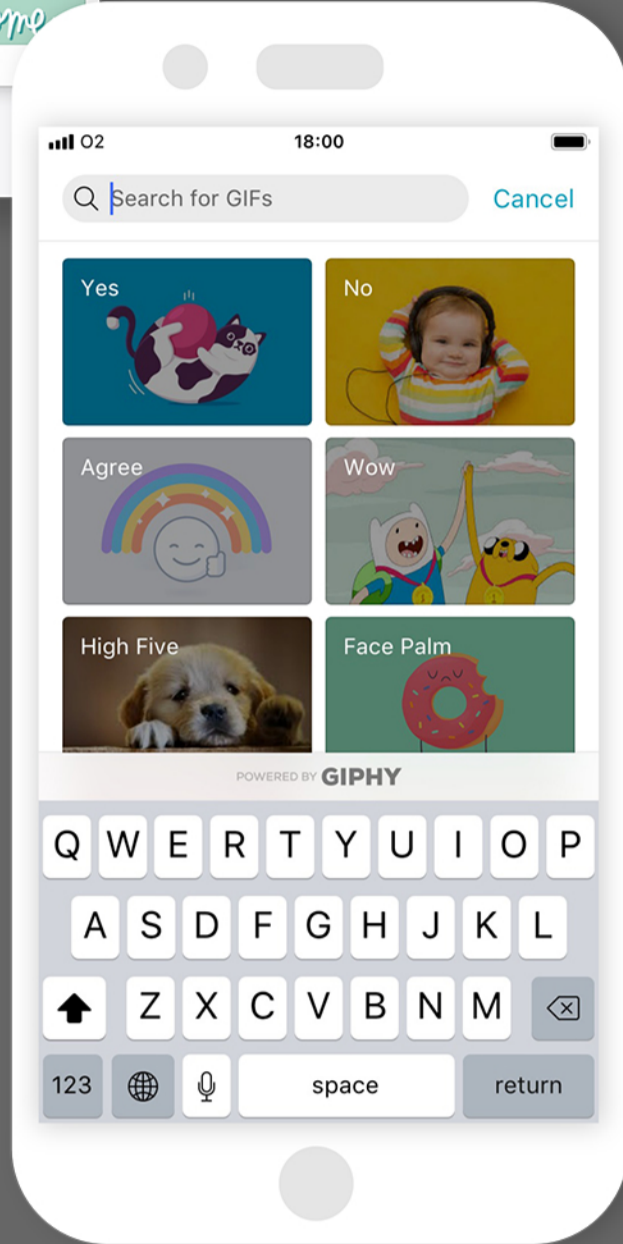

Share Wirelessly to a Webex Device



Share content wirelessly to a device even when not in a meeting.

Tap to start sharing your Android screen on devices.

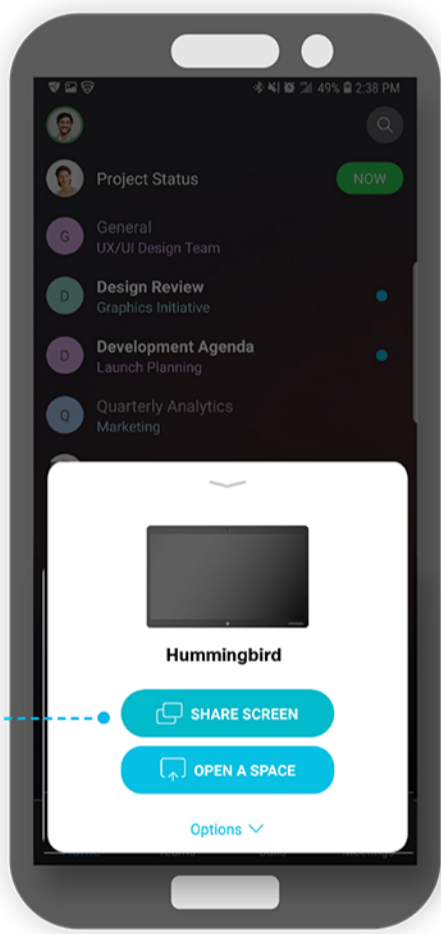

Screen sharing uses **Screen Recording** on your iPhone. Tap the tutorial to get it set up.

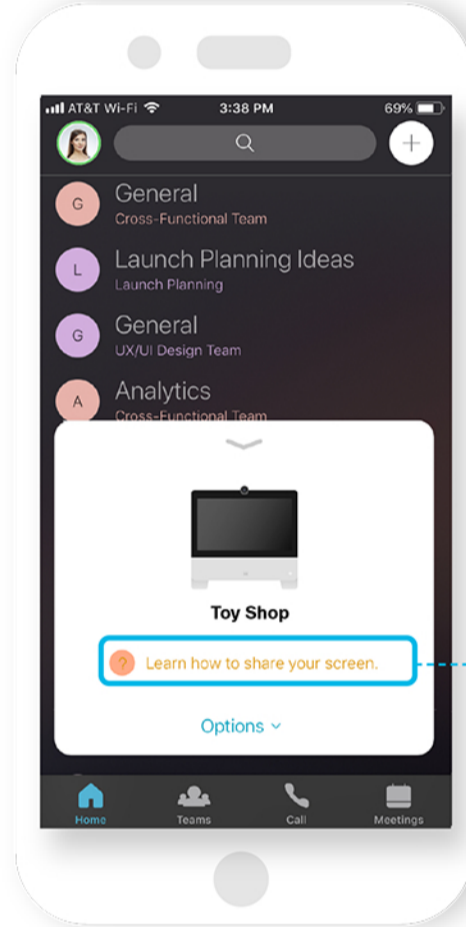

Mac

Increase Contrast

Make it easier to distinguish between the text and background colors.

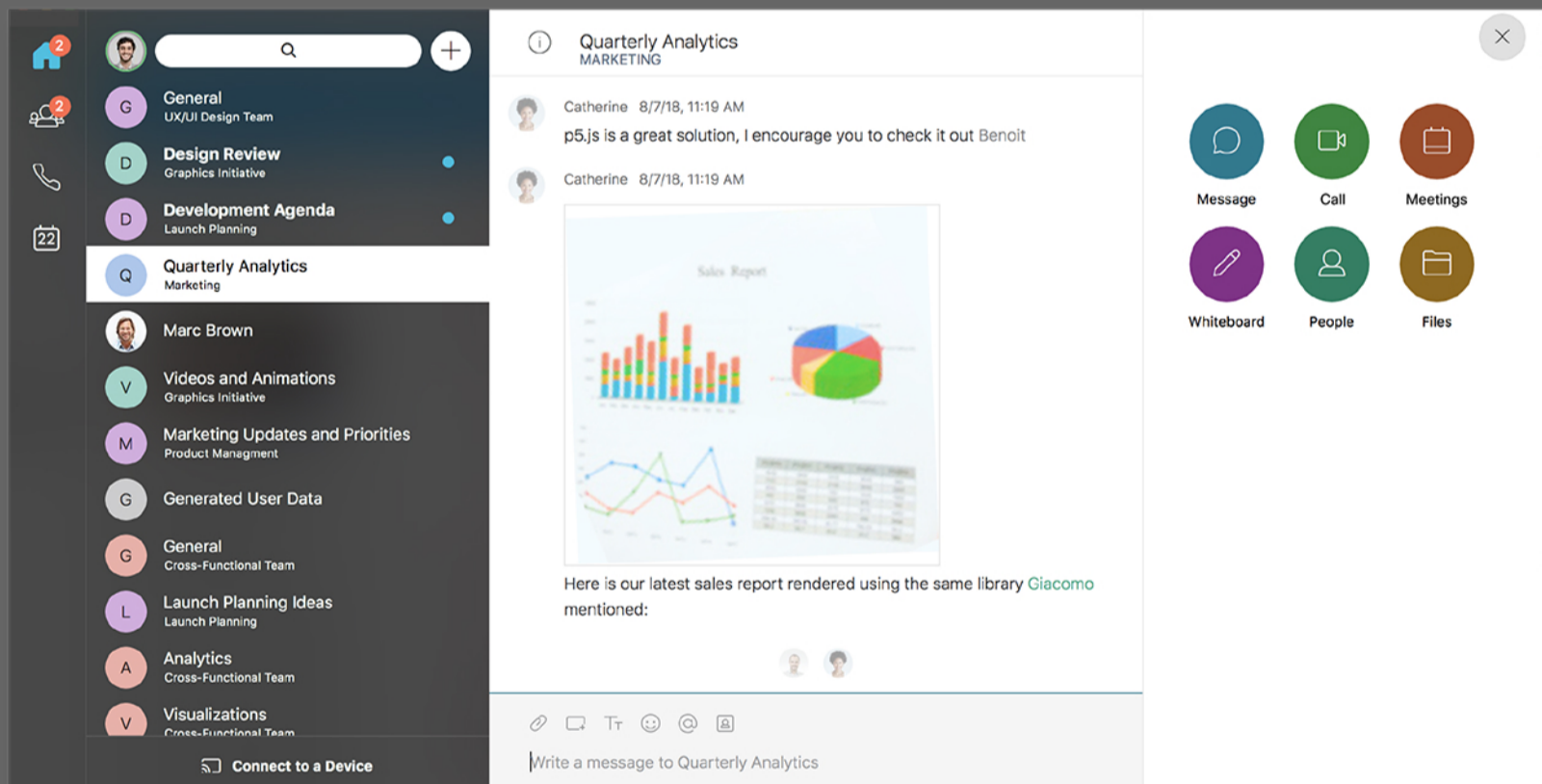

Click your profile picture, select **Preferences > General**, and then select **Increase contrast**.

See When Added to a New Space

desktop



You can easily see when you've been added to a new space. The **←** appears next to the space until you open it for the first time.

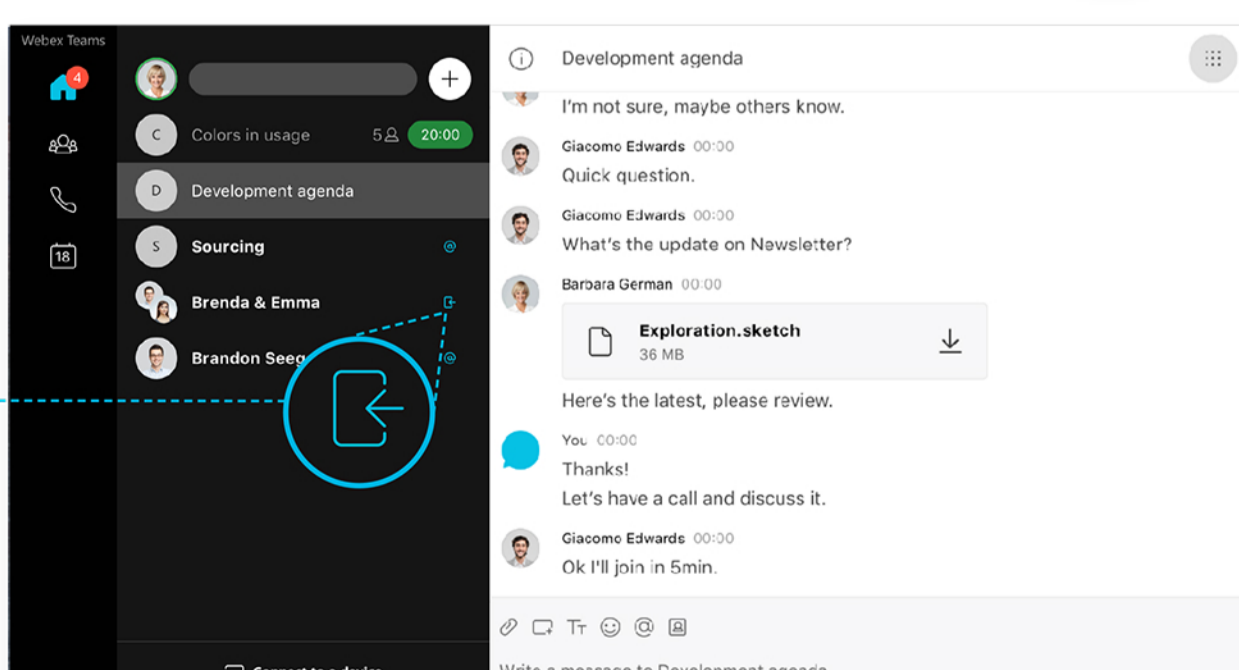

Try out the updated experience today.

Cisco Webex Teams

What's New in

Cisco Webex Teams

View Meetings

desktop

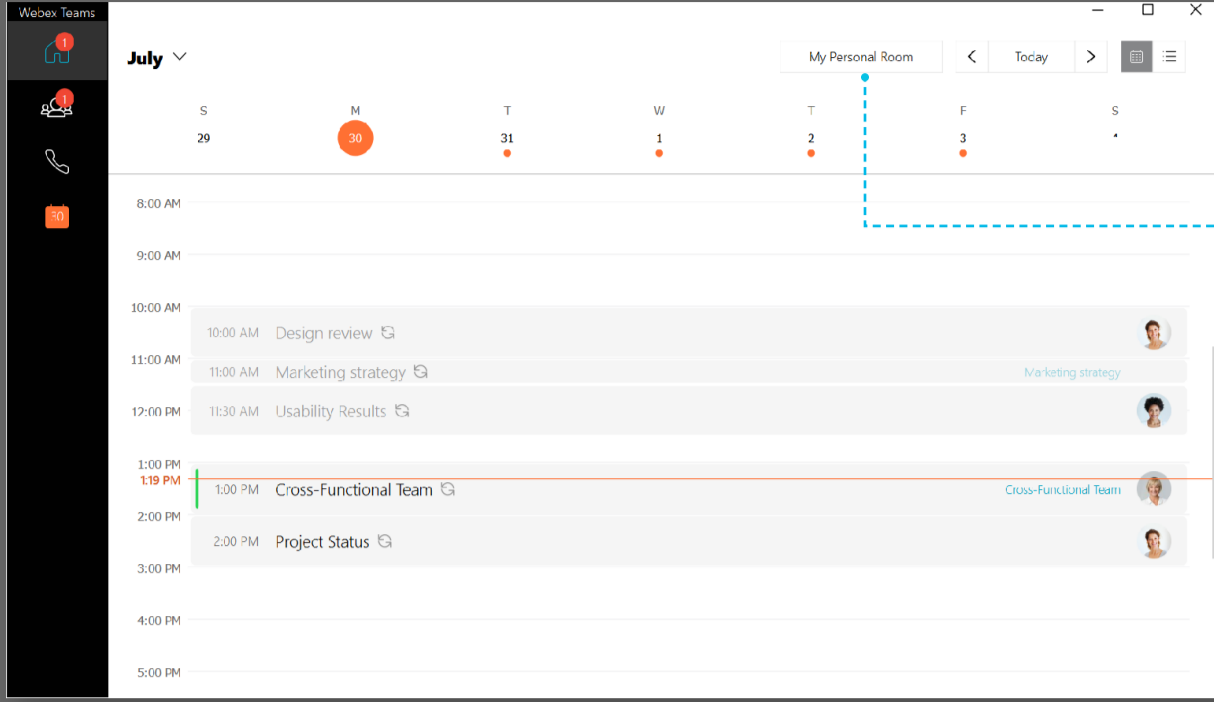

Start a meeting in your Webex Personal Room.

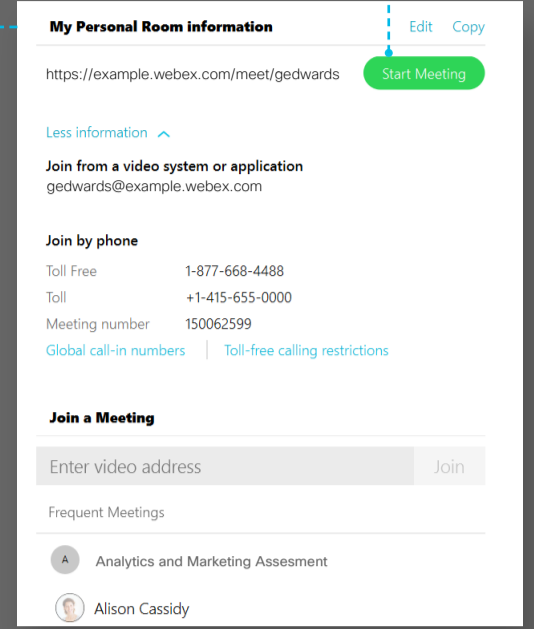

Month View

View your meetings from 1 week in the past to 4 weeks in the future.

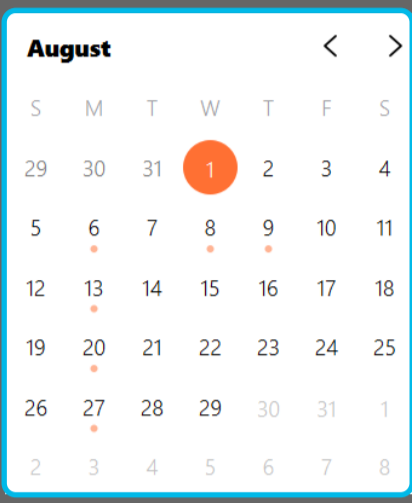

An orange dot highlights days on which you have a meeting.

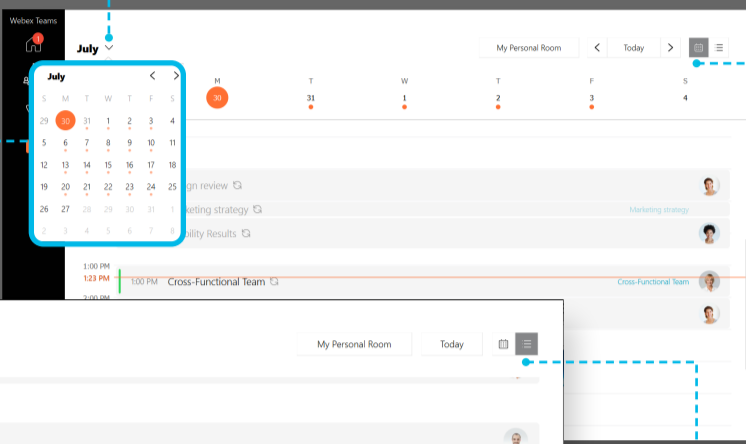

Day View
View your meetings in real time.

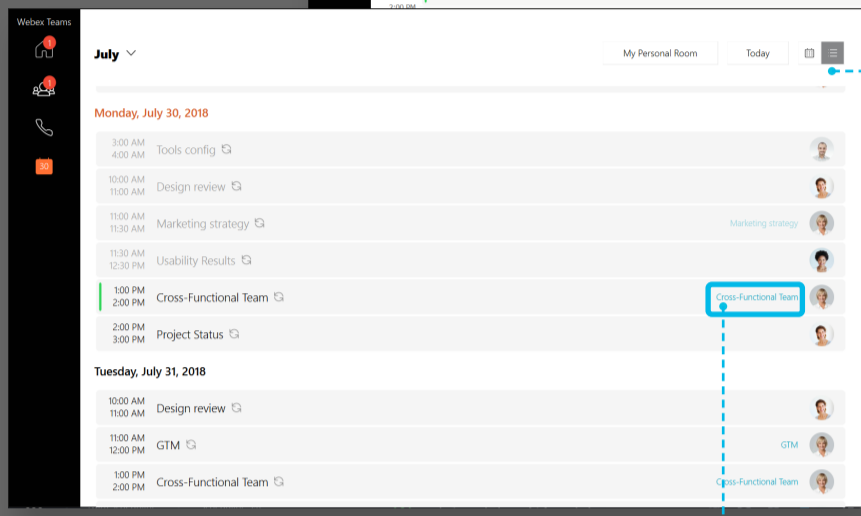

List View
View a consolidated list of your upcoming meetings.

Click a meeting to see its details.

Click to go to the space associated with the meeting.

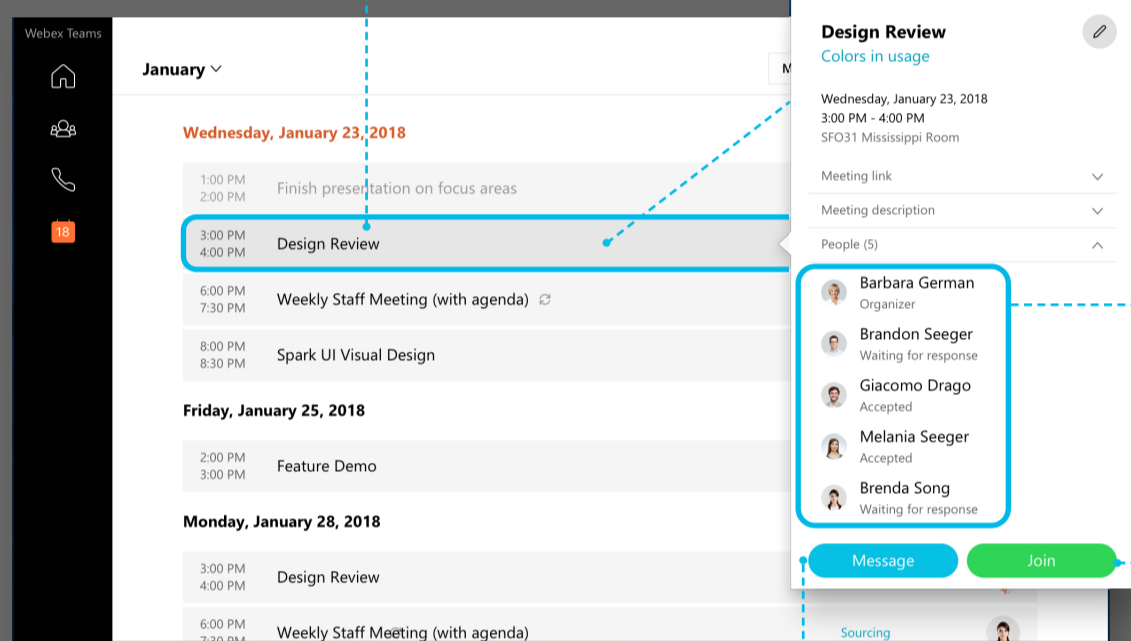

See who has responded to the meeting invite.

Click to join your meeting when it's ready to start.

Click to send a message to everyone in the space associated with the meeting.



desktop

Connect to a Device

You can use Wi-Fi to discover and connect to Webex devices. You'll only see this option if your administrator enables it for your organization.

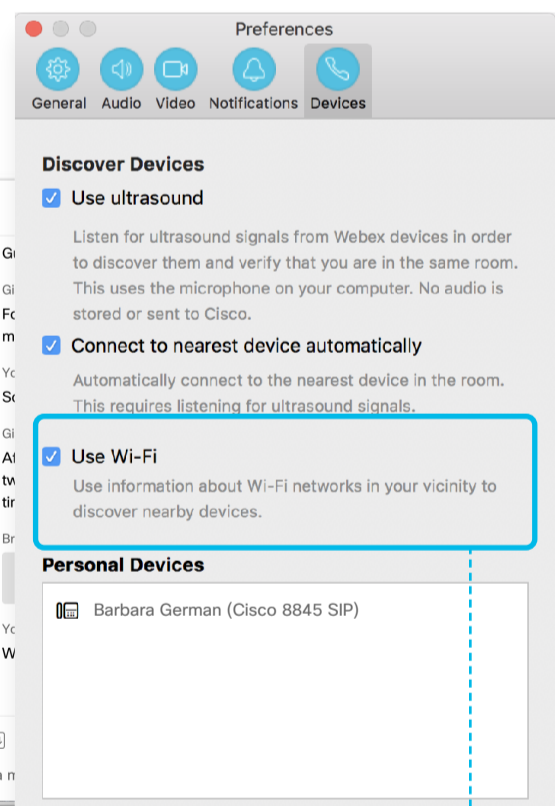
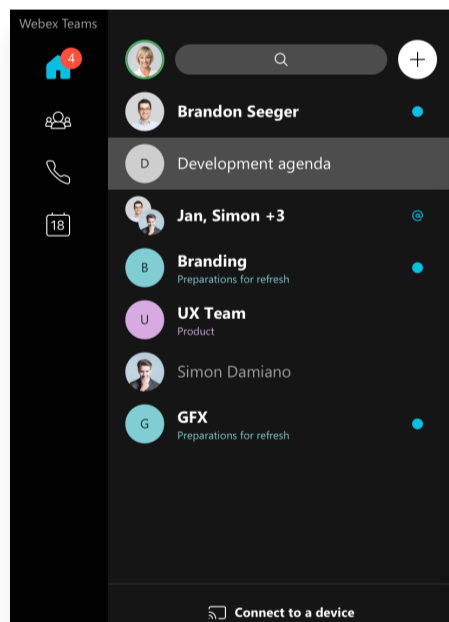

Connect to devices using Wi-Fi.

You can make sure that you're connecting to the right Webex Board, room, or desk device from the Webex Teams app.

If you've set the app to manually connect to Webex devices, you'll be prompted to enter a code shown on the device.

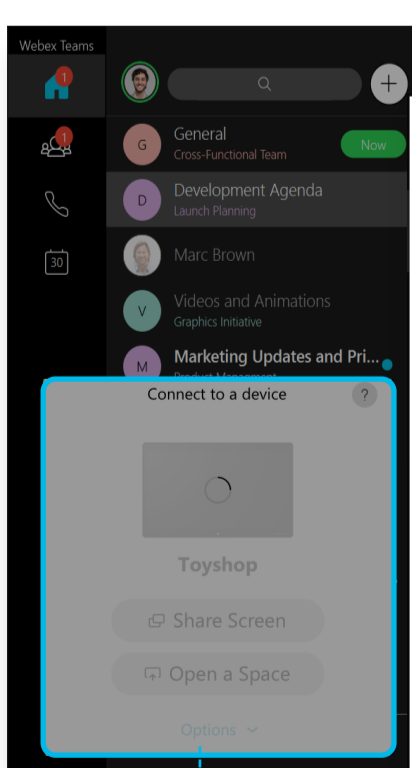

Select the device to use.

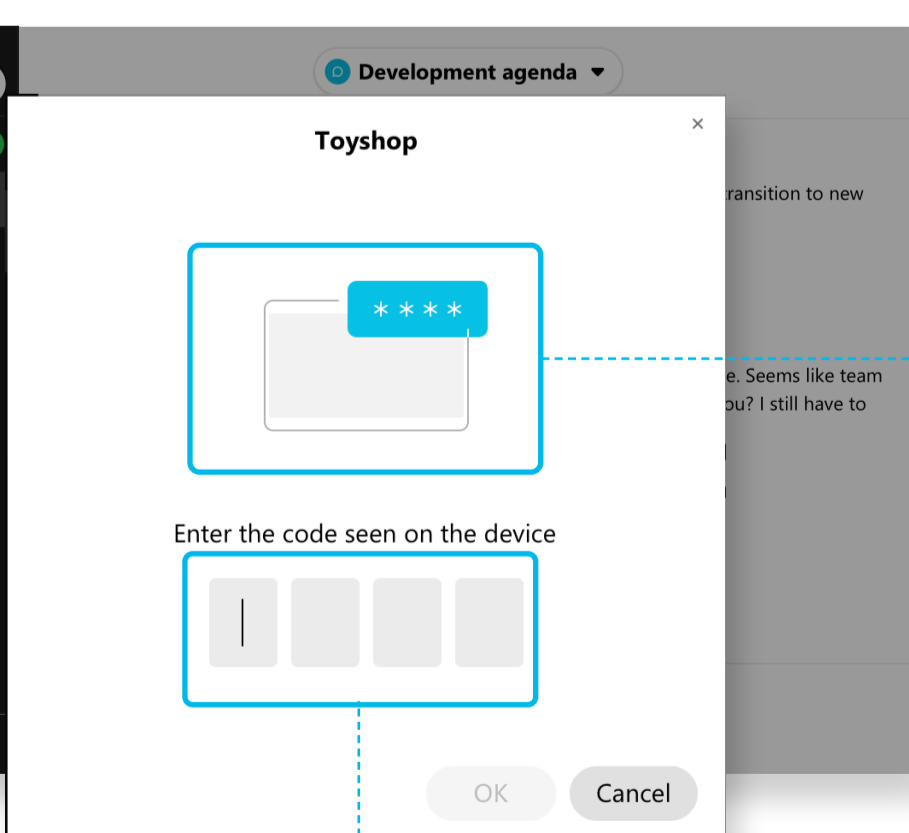

Enter the code into the app.

Try out the updated experience today.

Cisco Webex Teams

cs.co/CollabHelp

8/15/2018